



COMF ELECTRONIC COMPANY

EXPORTERS, IMPORTERS & MANUFACTURERS

香港 九龍灣臨興街 32 號美羅中心 1 期 15 樓 11 室

Flat 11, 15/F., METRO CENTRE 1, 32 LAM HING ST.,
KOWLOON BAY, HONG KONG

TEL: (852) 2770 5181

WEB: www.comf-hk.com

FAX (852)2798 8129

Email: sales@comf-hk.com

Product Data Sheet BH-144-1D



Specification

Cell Size:	4 X D Cell, UM-1, R20, LR20
Body:	Polypropylene, Black
Terminals:	Nickel plated brass
Springs:	Ø0.9mm Nickel plated spring steel
Compliance:	

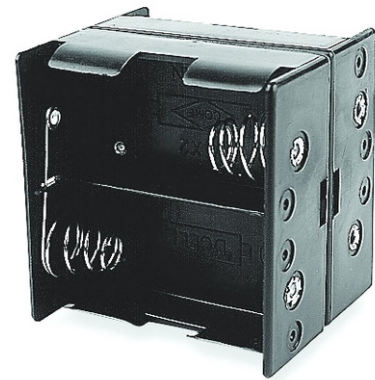

BH-144-1A Shown without Leads

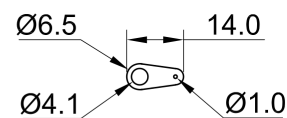
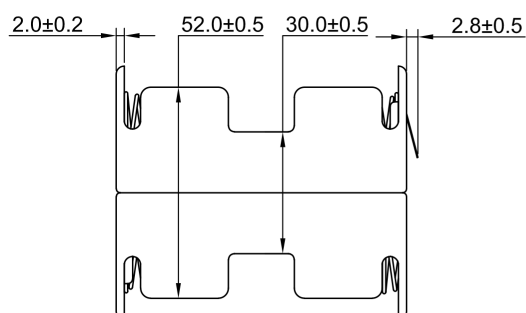
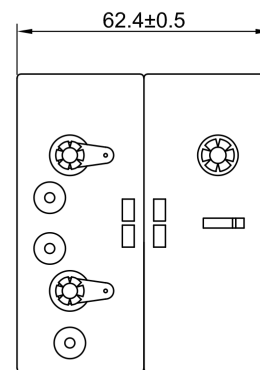
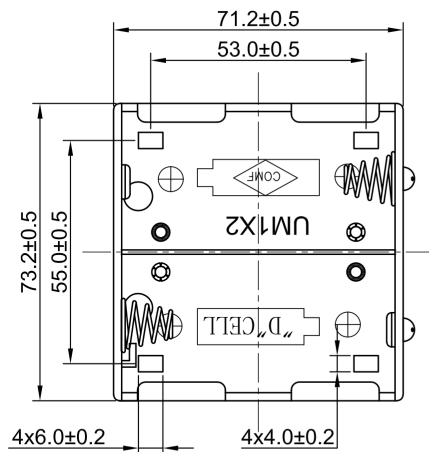

BIG SOLDER LUG